

LEGEND:

750mm x 1200mm CAR PARK DRAINAGE MANHOLE, 600mm x 600mm CLEAR OPE WITH D400 COVER

WASTEWATER STANDOFF MANHOLE

1200mm x 2000mm CAR PARK DRAINAGE PUMPING CHAMBER WITH MECHANICAL ACCESS COVER ACROSS FULL OPE

CAR PARK DRAINAGE PIPE UPVC SN8

ACO MULTIDRAIN M1000 No. 10.0 OR No. 0.0 CHANNEL WITH GRATINGS FOR LOAD CLASS D400 AS NOTED

100mmØ SERVICE CONNECTION

100mmØ HDPE SDR17 RISING MAIN

GENERAL NOTES:

1. ALL NOTED LEVELS ARE TO ORDNANCE DATUM, MALIN HEAD.

2. REFER TO ARCHITECT'S LAYOUT FOR ALL SET-OUT INFORMATION.

3. REFER TO ARCHITECT ARCHITECT'S DESIGN DRAWINGS FOR DETAILS OF PROPOSED SURFACE FINISHES.

4. ALL CAR PARK DRAINAGE IS TO BE INSTALLED IN ACCORDANCE WITH THE GREATER DUBLIN REGION CODE OF PRACTICE FOR DRAINAGE WORKS, THE BUILDING REGULATIONS PART H AND THE SITE DEVELOPMENT SPECIFICATION.

5. ALL WASTEWATER DRAINAGE IS TO BE INSTALLED IN ACCORDANCE WITH THE IRISH WATER CODE OF PRACTICE FOR WASTEWATER INFRASTRUCTURE, THE BUILDING REGULATIONS PART H AND THE SITE DEVELOPMENT SPECIFICATION.

6. ALL DRAINAGE COVER LEVELS ARE TO BE COORDINATED WITH ARCHITECT DESIGN FINISH DETAILS.

7. ALL CONNECTIONS TO NEW DRAINAGE NETWORKS ARE TO BE MADE AT AN ANGLE OF 90° OR IN THE DIRECTION OF FLOW.

8. THE CONTRACTOR IS RESPONSIBLE FOR CONFIRMATION OF PRESENCE ALL EXISTING UTILITIES, IF ANY, ALONG ROUTE OF PROPOSED DRAINAGE NETWORKS - BY INTRUSIVE INVESTIGATION OR EQUAL.

9. ALL NEW DRAINAGE INFRASTRUCTURE TO BE JET CLEANED AND CCTV SURVEYED, WITH ANY NOTED DEFECTS REMEDIATED, ON COMPLETION OF WORKS, TO THE SATISFACTION OF THE LOCAL AUTHORITY.

10. REFER TO ARCHITECT AND WATERPROOFING DESIGN SPECIALIST FOR DETAILS OF NEWTON DRAINAGE REQUIREMENTS. ALL NEWTON DRAINAGE ON THIS DRAWING IS SHOWN INDICATIVELY FOR COORDINATION PURPOSES.

11. REFER TO ARCHITECT AND M&E ENGINEERING DESIGN DRAWINGS FOR CONFIRMATION OF LOCATION AND SPECIFICATION OF FLOOR GULLIES.

12. REFER TO M&E ENGINEERING DRAWINGS FOR CONFIRMATION OF WASTE AND SANITARY POP-UP / OUTLET LOCATIONS.

13. ALL CHAMBER COVERS TO BE DOUBLE SEALED, AND D400 WHERE LOCATED IN VEHICULAR AREAS.

UNDER-CROFT CAR PARK DRAINAGE NETWORK DESIGN TABLE								
USMH	USCL (m)	USIL (m)	PN	Fall (m)	Slope (1:X)	DSCL (m)	DSIL (m)	Dia (mm)
VVWB1	20.625	19.200	VVWB1.000	0.064	200.0	20.625	19.136	225
VVWB2	20.625	19.275	VVWB2.000	0.064	136.3	20.625	19.211	150
VVWB3	20.625	19.136	VVWB1.001	0.211	139.4	20.625	18.925	225
VVWB4	20.625	19.200	VVWB3.000	0.205	200.0	20.625	18.995	225
VVWB5	20.625	18.995	VVWB3.001	0.070	200.0	20.625	18.925	225
VVWB6	20.625	18.925	VVWB1.002	0.011	200.0	20.625	18.914	225

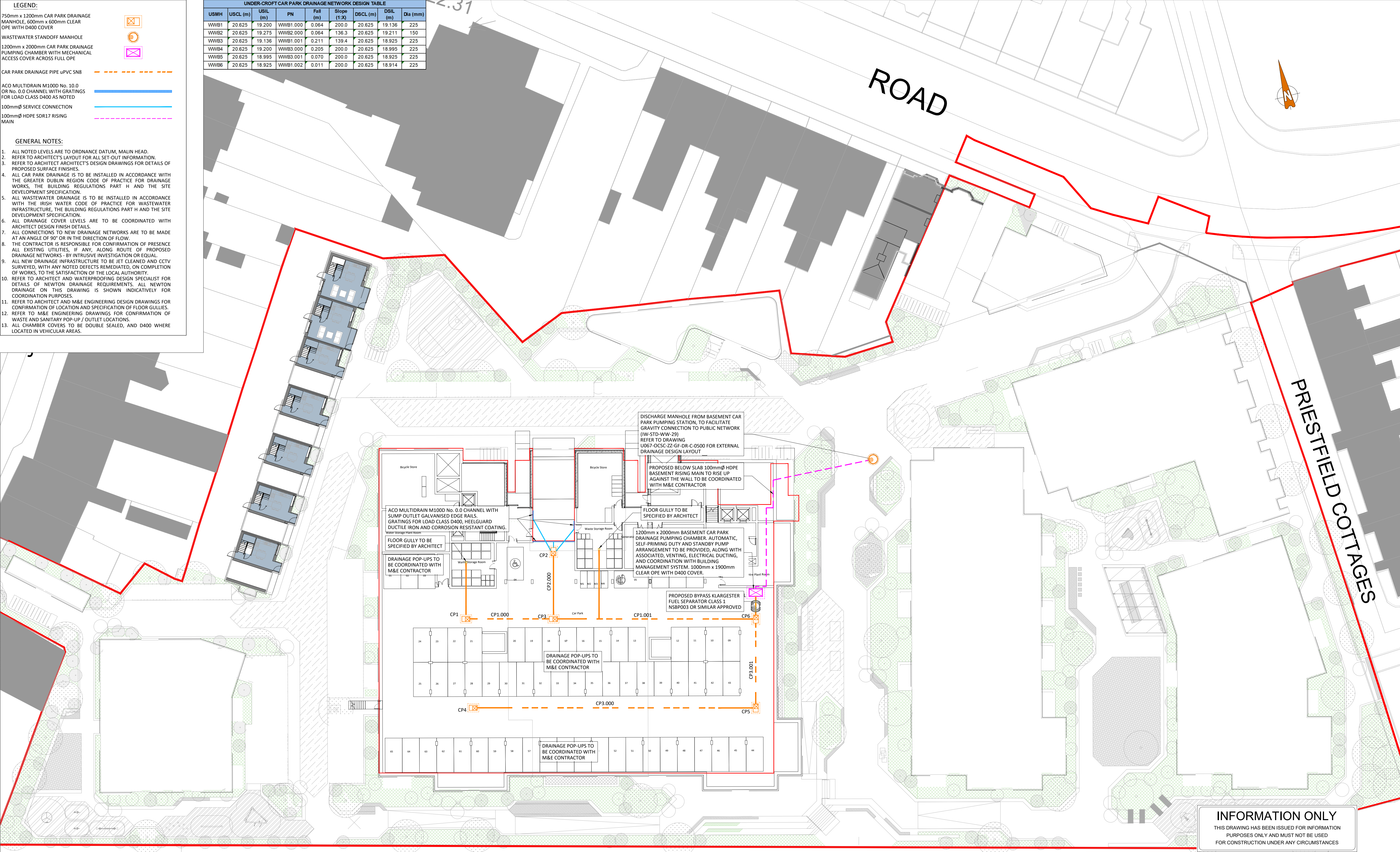

ORDNANCE SURVEY OF IRELAND LICENCE NO. CVAL50213875 © GOVERNMENT OF IRELAND

- ALL DIMENSIONS ARE IN METERS UNLESS NOTED OTHERWISE.
- ONLY WRITTEN DIMENSIONS SHALL BE USED. NO DIMENSIONS SHALL BE SCALED FROM THE DRAWING.
- ALL LEVELS ARE IN METERS AND ARE TO ORDNANCE DATUM, MALIN UNLESS NOTED OTHERWISE.
- ALL CO-ORDINATES ARE IN METERS AND ARE TO IRISH TRANSVERSE MERCATOR UNLESS NOTED OTHERWISE.
- THIS DRAWING IS TO BE READ IN CONJUNCTION WITH ALL OTHER RELEVANT ENGINEERING DRAWINGS AND SPECIFICATIONS.
- NO PART OF THIS DOCUMENT MAY BE REPRODUCED OR TRANSMITTED IN ANY FORM OR STORED IN ANY RETRIEVAL SYSTEM OF ANY NATURE WITHOUT THE WRITTEN PERMISSION OF O'CONNOR SUTTON CRONIN AS COPYRIGHT HOLDER EXCEPT AS AGREED FOR USE ON THE PROJECT FOR WHICH THE DOCUMENT WAS ORIGINALLY ISSUED.
- ANY DISCREPANCIES NOTICED SHOULD BE DISCUSSED AND CLARIFIED PRIOR TO PROCEEDING.

Rev No.	Date	Revision Note	Drn by	Chkd by
P01	30.04.21	SUITABLE FOR INFORMATION	AB	MK
P02	25.02.22	SUITABLE FOR INFORMATION	EH	MK

Rev No.	Date	Revision Note	Drn by	Chkd by



Head Office,
9 Prussia Street,
Dublin 7,
D07 KT57

TEL +353 (0)1 8682000

e: contactus@ocsc.ie
w: www.ocsc.ie

Dublin | London | Belfast | Galway | Cork



Client: U AND I (WHITE HEATHER) LIMITED

Project: WHITE HEATHER

SOUTH CIRCULAR ROAD

Title: UNDER-CROFT CAR PARK DRAINAGE

DESIGN LAYOUT

Code	Originator	Zone	Level	Type	Role	Number	Status	Revision		
U067	OCSC	ZZ	B1	DR	C	0500	S3	P02		
Date:	APR'21	Scale:	1:250	@ A1	Drn by:	AB	Chkd by:	MK	Aprvd by:	AH